

Video Door Intercom System

Quick Guide



Please read all of these instruction before installation

1> General Description

The door video intercom monitor combines Video, Intercom, Monitoring, Indoor Unlocking, Night Vision capabilities (Mute function optional) in-one and enables you to see who's outside your door---without having to open the door.
It is a 4-wire system with plug-and-play connector for easy installation. The outdoor unit has several call buttons(2/3/4/5/6/8/10/12 optional) which allows the visitor call separate house.It is a great system for home intercom and security.

2> Product Introduction

• Indoor Unit

Below monitors are just for reference.If monitors in other color or size are required,please contact us for quotation.

- ① Answer

② Unlock

③ Monitor

④ Mute
- ⑤ Volume Regulator

⑥ Ringtone Regulator

⑦ Brightness Regulator

⑧ Color Regulator
- ⑨ Indicator Light

⑩ Microphone

⑪ Null



• Outdoor Unit



3> Specification

| Indoor Unit | |
|-----------------------------|--------------------|
| Screen | TFT-LCD |
| Effective Pixels | 800*480 |
| Call Holding Duration | 30s |
| Monitoring Duration | 90s |
| Power Consumption(working) | <10w |
| Power Consumption(standby) | <0.5w |
| Adapter Input | AC100-240V/50~60HZ |
| Adapter Output | DC15V/1.2A |
| Working Temperature | -20°C~60°C |
| Installation | Surface Mount |
| Cable for Monitor to Camera | 4 Core |

| Outdoor Unit | | |
|---------------------------|------------------------|------------------------|
| Model NO. | XSL-520 | XSL-530 |
| Function | Call Button | Call Button ID Card |
| Sensor | COMS | |
| Horizontal Resolution | 680TVLine | |
| Lens | 3.6mm | |
| Minimum Illumination | 0.1LUX | |
| View Angle | 92° | |
| IR Distance | 1.5m | |
| Ingress Protection Rating | Ip54 | |
| Material | Aluminum Alloy | |
| Working Temperature | -20°C~60°C | |
| Installation | Surface&Embedded Mount | |
| Power Supply | / | DC15V 1.2A |
| Reading Capacity | / | 500pcs Cards |
| Reading Distance | / | 2-5cm |
| Card Type | / | 125Khz RFID |

4> Main Function

• Intercom

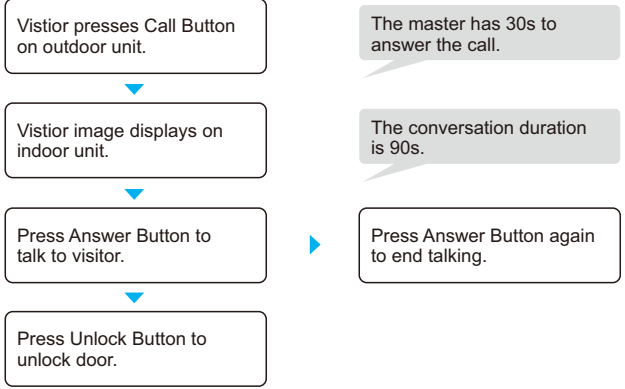

• Monitoring

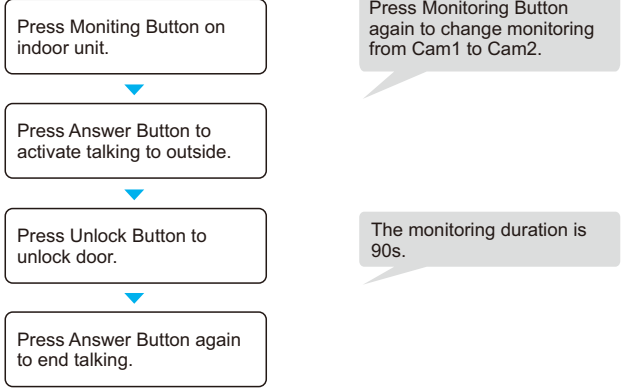

• Monitoring

Press Monitoring Button [Icon] on indoor unit,then press Mute Button on the indoor unit to turn on/off the voice.

Other Operation of Indoor Unit

Ringtone Setting

Press Monitoring Button, then short press Ringtone Regulator Button to choose the ringtone (36 ringtones selectable).

Ringtone Volume Setting

Press Monitoring Button, then press Ringtone Regulator Button, it rings. Then keep pressing this button about 3s to change ring volume to higher or lower. There are three levels for choice.

Ringtone-back Cancellation

When visitor presses Call Button, outdoor unit and indoor unit ring. The jumper can be removed on monitor to cancel the "Ding-Dong" sound of outdoor unit.

Brightness, Color and Communication Volume can be adjusted by turbines (on the right side)

ID Card Instruction for XSL-530

Add User Card

(Green keyfob is Add Card. Red keyfob is Delete Card.)

1. swipe Add Card (buzzer Di)
2. swipe unregistered cards continuously (buzzer Di for each successfully registered card)
3. swipe Add Card to quite adding card status (buzzer Di Di)

In standby status, buzzer will sound Di Di Di if an unregistered card is swiped.

Delete a Single User Card

1. swipe Delete Card (buzzer Di)
2. swipe registered card continuously (buzzer Di)
3. swipe Delete Card to quite deleting card status (buzzer Di Di)

Delete All User Cards

1. swipe Delete Card (buzzer Di)
2. swipe Add Card (buzzer Di)
3. swipe Delete Card again (buzzer Di, then Di 6 times), then all user cards are deleted.

Set Add Card & Delete Card

disconnect power, insert J5 to 2-3 site connect power into setting status (buzzer Di) swipe 1st card to be Add Card (buzzer Di) swipe 2nd card to be Delete card (buzzer Di) disconnect power, insert J5 from 2-3 to 1-2 site

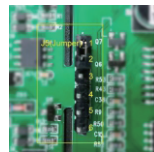

5 Wiring Diagram

XSL-520 with NC (Fail Safe) Lock

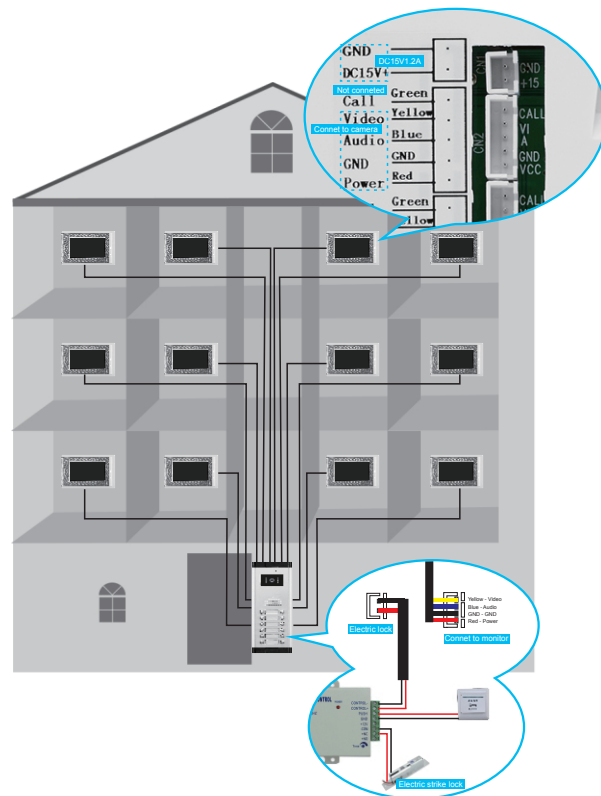

XSL-520 with Electric Rim Lock (Fill Secure)&Central Power Supply

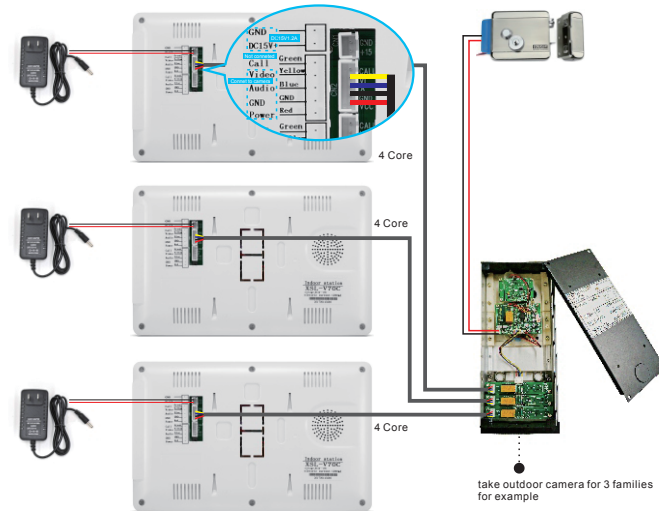

XSL-530 with NC (Fail Safe) Lock

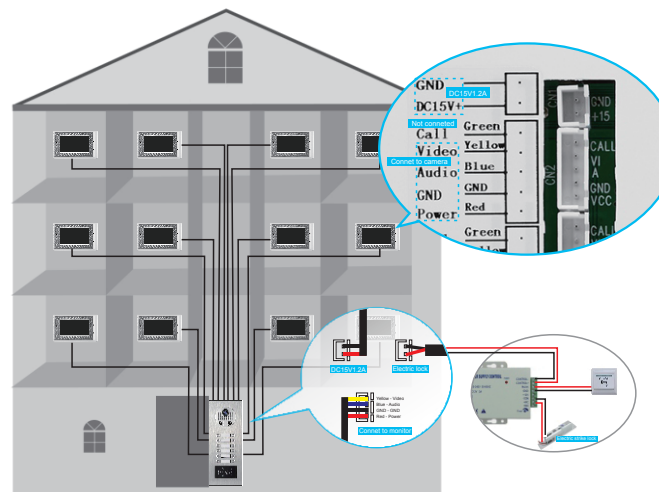

XSL-530 with Electric Rim Lock (Fill Secure)&Central Power Supply

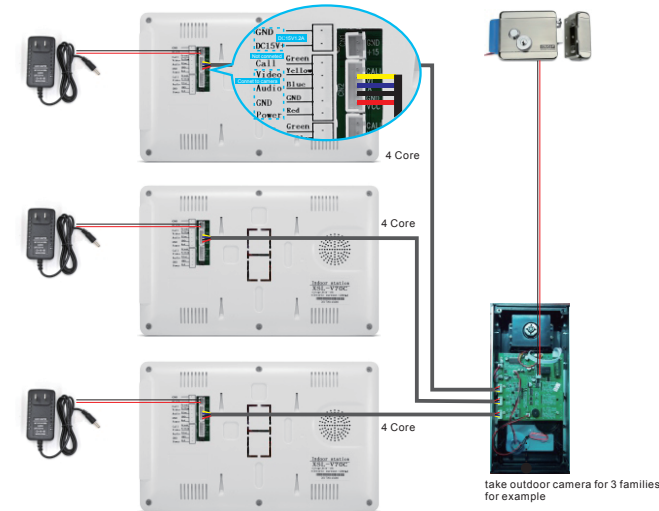

6 Kind Reminder

Below are compatible electrical locks. An extra power supply controller is needed except for electric rim lock. Please check above wiring diagram for more information.



XSL-520 does not need to connect with power adapter and each call button can only connect with 1 monitor.

XSL-530 needs to connect with DC15V power adapter. Each call button max supports 4 monitors.

This system supports maximum 100m length of wiring cables for stable performance. Cable Requirements:

| Length of Cable | Conductor Cross-sectional Area |
|---------------------|--------------------------------|
| 0m ≤ Length ≤ 30m | RVV4*0.3mm ² |
| 30m ≤ Length ≤ 50m | RVV4*0.3mm ² |
| 50m ≤ Length ≤ 80m | RVV4*0.75mm ² |
| 80m ≤ Length ≤ 100m | RVV4*1.0mm ² |

Two-core network cable wire combined as one core, the longest distance up to 50 meters.

7 Installation

